

New Product



We turn out
top quality



ERNST HEINRICH

Raffee

DIN 89 285 Cable Gland for Shielded Cables

The Raffee cable gland has been specially developed for the internal and external installation of EMC-shielded cables. Raffee represents modern, elegant design. The **newly developed grounding insert** is based on the DIN 89 345 norm and provides the same support surface for the shielding. Thanks to its optimized geometrical form, it achieves **high EMC damping values** up to

100% of the shielded cable. A torsion security element enables **anti-rotation cable mounting** as well as **Class B strain relief** based on EN50262 in the main areas.

The Raffee is available in a standard brass version, but can be delivered with a **chrome** or **nickel-plated surface** as well as other materials like A2/A4 steel or aluminum.



Technical Data

- Connecting threads from M16 x 1.5 to M105 x 2 according to the DIN 89 285 or EH norms
- Cable diameters up to 78.0 mm
- Protection rating: IP 68
- Temperature range: -40 to +100 °C
- Class B strain relief in the main sizes based on EN50262
- Material: brass (MS58 – CuZn39Pb3), A2 steel (1.4305), A4 steel (1.4571), aluminum (AlMgSi alloys)
- Surface: brass (blank, chrome or nickel-plated)

Publication Date: October 2014 · Information subject to change

ERNST HEINRICH GmbH & Co. KG

Winsbergring 10 Telephone +49 (0)40 890 69 29 -0
22525 Hamburg Telefax +49 (0)40 890 69 29 -29
Germany

info@ernst-heinrich.de
www.ernst-heinrich.de

www.ihre-kabelverschraubung.de



GL Systems Certification

New Product



We turn out
top quality



ERNST HEINRICH

Raffee

DIN 89 285 Cable Gland for Shielded Cables

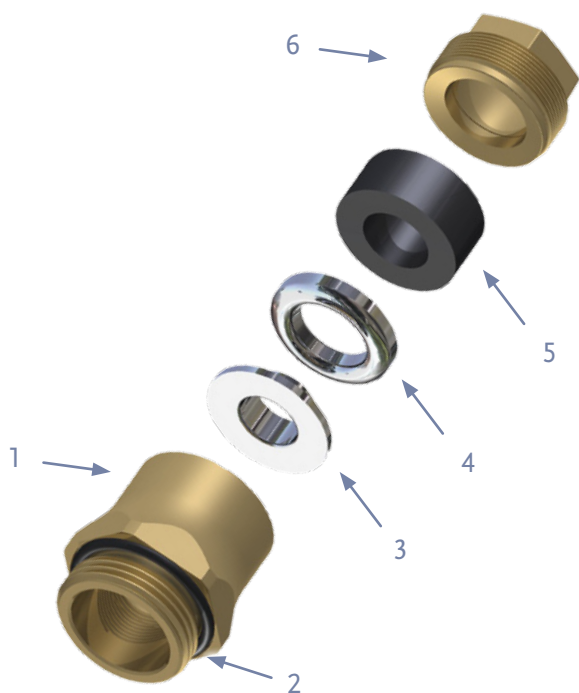

Parts List

Item No.	Name	Quantity
1	Body	1
2	Connecting Thread Seal	1
3	Grounding Insert (inner)	1
4	Grounding Insert (outer)	1
5	Washer	1
6	Torsion Protection Element	1

Product Variants

Type	Thread	Cable Ø	L1	L2	AF1	AF2
Raffee 16	M16 x 1.5	6.0 – 7.5	28	7	19	13
Raffee 18	M18 x 1.5	7.0 – 10.5	28	8	22	15
Raffee 24	M24 x 1.5	7.0 – 17.5	32	8	27	19
Raffee 30	M30 x 2.0	16.0 – 20.5	35	9	32	25
Raffee 36	M36 x 2.0	18.0 – 26.5	38	10	38	30
Raffee 45	M45 x 2.0	26.0 – 32.5	41	10	50	41
Raffee 56	M56 x 2.0	32.0 – 41.5	44	11	60	50
Raffee 72	M72 x 2.0	41.0 – 56.5	48	11	80	65
Raffee 80*	M80 x 2.0	56.0 – 68.0	51	13	85	75
Raffee 105*	M105 x 2.0	68.0 – 78.0	Coming soon			

Materials

(Measurements in mm)

Material	Surface (optional)
Brass: CuZn39Pb3	Blank, chrome or nickel-plated
A2 Steel: 1.4305	-
A4 Steel: 1.4571	-
Aluminum: AlMgSi alloy	-

(Other materials upon request)

- Connecting threads based on DIN 89 285 or EH norms
- Cable diameters up to 78.0 mm
- Protection class: IP 68
- Class B strain relief based on EN50262 for the main sizes
- Equipment type: EMC

Publication Date: October 2014 · Information subject to change

ERNST HEINRICH GmbH & Co. KG

Winsbergring 10
22525 Hamburg
Germany

Telephone +49 (0)40 890 69 29 -0
Telefax +49 (0)40 890 69 29 -29

info@ernst-heinrich.de
www.ernst-heinrich.de

www.ihre-kabelverschraubung.de



GL Systems Certification